

Number
63638

EXHIBIT "A"

A portion of MAIN PARCEL, as said MAIN PARCEL is shown on that certain map entitled "Record of Survey, Lands of E. Mazza, S. Martinelli, and L. Filippini 1254 OR 456" filed December 10, 1974 in Book 216 of Maps, Pages 18 and 19, Sonoma County Records, more particularly described as follows:

PARCEL 1 (63638-1):

BEGINNING at the northwesterly corner of that parcel of land as described in the Quitclaim Deed (State Parcel Number 62550) recorded April 14, 2014 under Document Number 2014024898, Official Records of Sonoma County; said corner being the westerly terminus of the curve with a radius of 229.99 feet as described in said Quitclaim Deed; thence southwesterly along the continuation of said curve, from a radial line that bears N. 55°46'46" W., along a curve to the left with a radius of 229.99 feet, through an angle of 15°27'02", an arc length of 62.02 feet to a point on the general westerly line of San Antonio Road; thence along said general westerly line of said San Antonio Road, S. 18°37'56" W., 61.25 feet; thence S. 71°22'43" E., 34.11 feet to a point on the westerly line of said parcel; thence along said westerly line of said parcel, N. 06°48'27" E., 125.15 feet to the POINT OF BEGINNING.

CONTAINING 2,434 square feet, more or less.

This quitclaim deed is made for the purposes of a freeway and the undersigned hereby releases and relinquishes to the grantee any and all abutter's rights, including access rights, appurtenant to the remaining property in which the undersigned has some right, title or interest, in and to said freeway.

The bearings and distances used in the above description are on the California Coordinate System of 1983 (Epoch 1991.35), Zone 3. Multiply the above distances by 1.0000383 to obtain ground level distances.

This real property description has been prepared by me, or under my direction, in conformance with the Professional Land Surveyors Act.

Signature: 
 Licensed Land Surveyor

Date: 04/03/2018



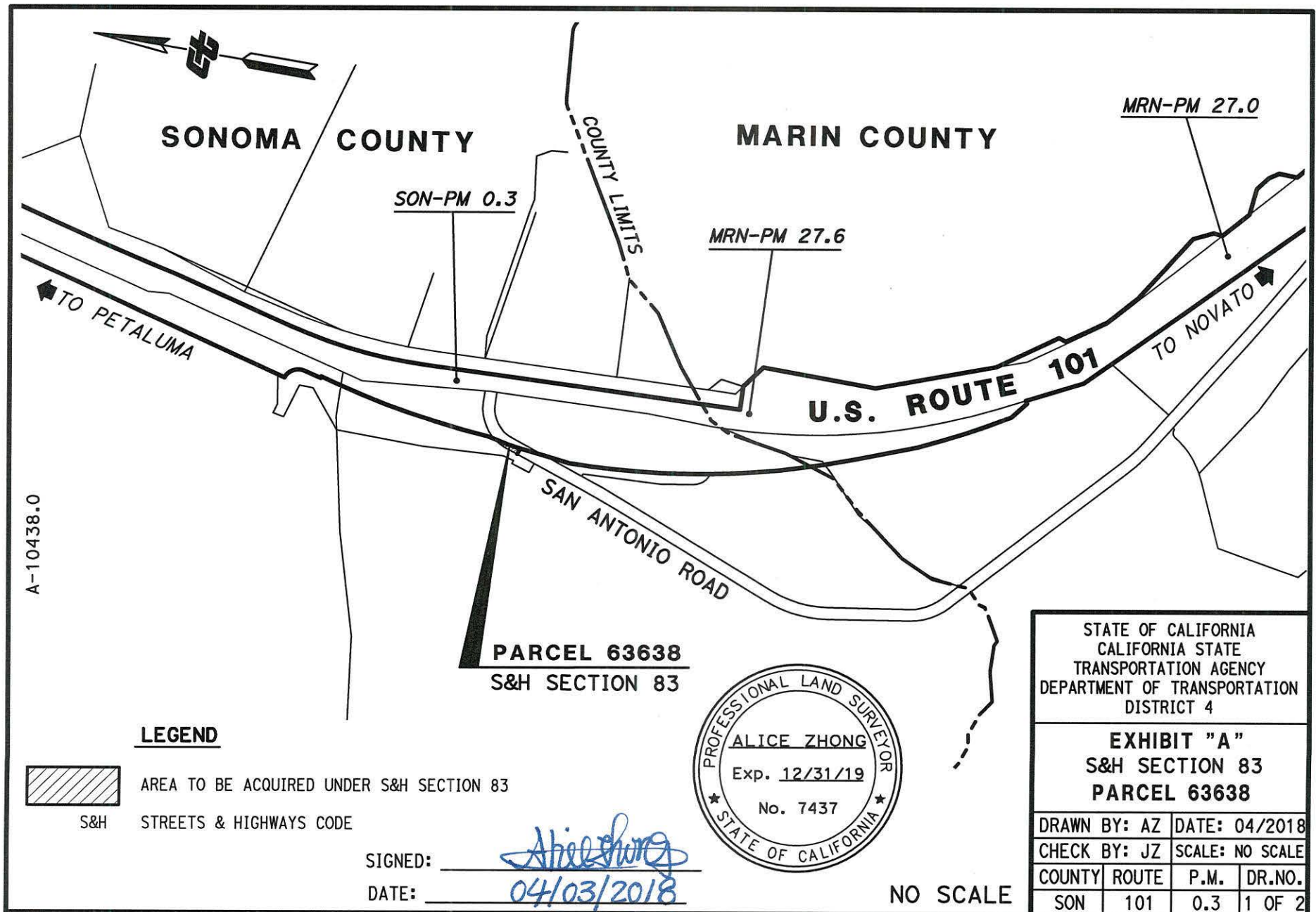

Coordinates and bearings are on CCS 1983, Zone 3, Epoch 1991.35. Distances and stationing are grid distances. Multiply by 1.0000383 to obtain ground distances. All distances are in feet unless otherwise noted.

SONOMA COUNTY

State R/W line



U.S. ROUTE 101

Access Rights previously acquired

LEGEND



AREA TO BE ACQUIRED UNDER S&H SECTION 83

- P.O.B. POINT OF BEGINNING
 S&H STREETS & HIGHWAYS CODE
 R/W RIGHT OF WAY
 ° DIMENSION POINT
 — ACCESS PROHIBITED
 SQ. FT. SQUARE FEET
 (T) Total
 (R) Radial Bearing

S05°31'53"E

58.75'
S87°54'06"W

$\Delta=53^{\circ}40'32''$
 $L=215.48'$
 $R=229.99'$
 $\Delta=69^{\circ}07'54''(T)$
 $L=277.50'(T)$

30.05'

30.00'

60.56'
S87°54'06"W

$R=169.99'$
 $\Delta=69^{\circ}05'00''$
 $L=204.96'$

S02°06'43"E

769.97'

P.O.B.
N55°46'46"W(R)

State R/W line

S03°27'26"E 407.16'

63638-1

S&H SECTION 83
2,434 SQ. FT.

$\Delta=15^{\circ}27'02''$
 $L=62.02'$

N71°13'48"W(R)
S14°06'08'W

16.00'
N71°22'43"W

98.32'
S18°12'46"W

401.64'(T)
184.92'

34.11'
S71°22'43"E
126.36'
S06°48'27"W

S18°37'56"W

Centerline
S18°37'56"W
SAN ANTONIO ROAD

52.80'
S71°22'43"E

242.07'
401.65'(T)

SCALE: 1" = 100'



STATE OF CALIFORNIA
CALIFORNIA STATE
TRANSPORTATION AGENCY
DEPARTMENT OF TRANSPORTATION
DISTRICT 4

EXHIBIT "A"
S&H SECTION 83
PARCEL 63638

DRAWN BY: AZ	DATE: 04/2018
CHECK BY: JZ	SCALE: 1"=100'
COUNTY ROUTE	P.M. DR.NO.
SON 101	0.3 2 OF 2

A-10438.8