



Sonoma
Water

Variance for Sewer Main Extension

PUBLIC HEARING

Douglas Messenger, PE
Water Agency Engineer
707-547-1952

douglas.messenger@scwa.ca.gov

    sonomawater.ca.gov



Sonoma Valley Sanitation District

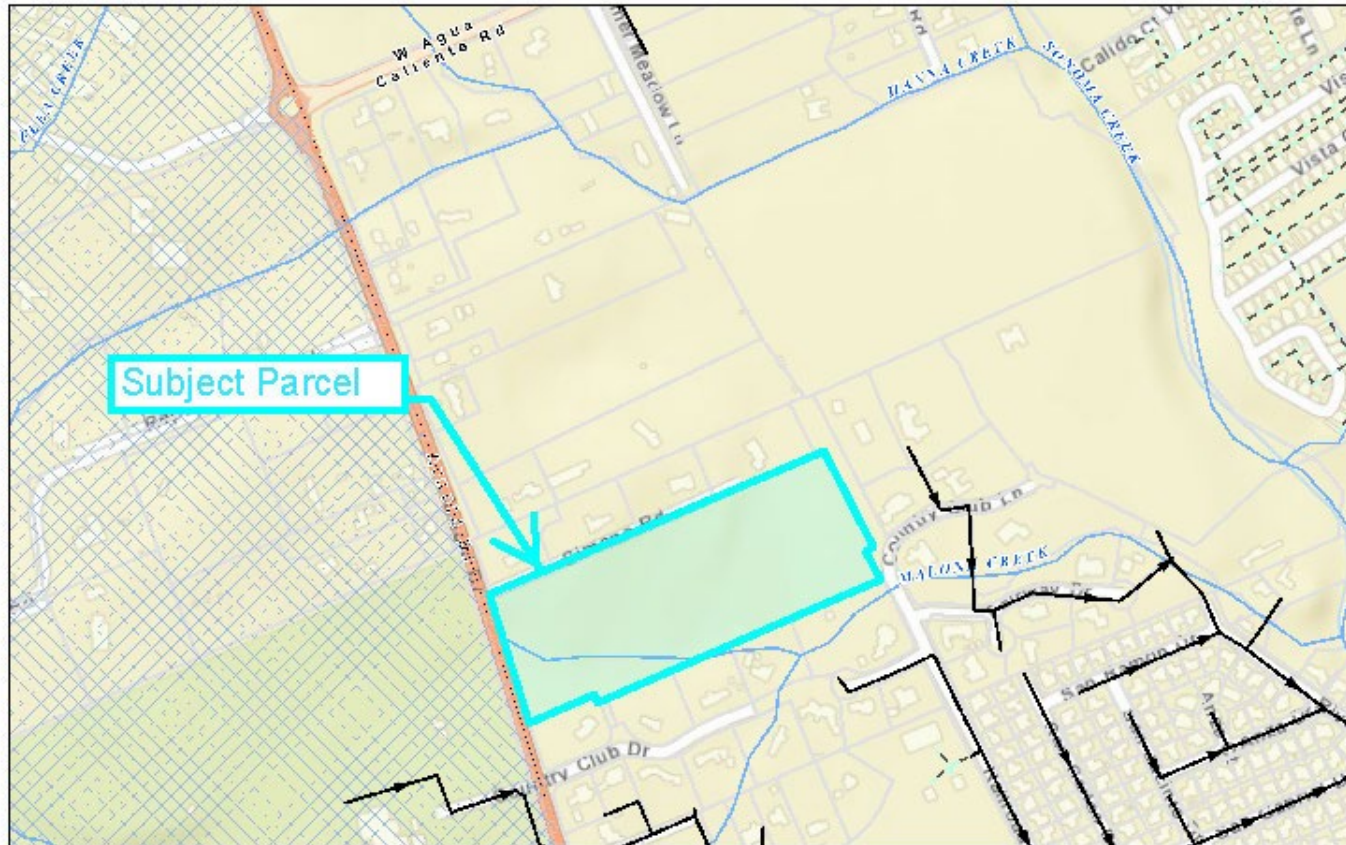

August 5, 2019

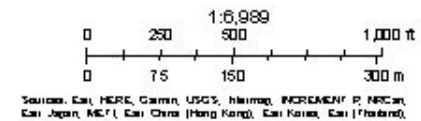

Copyright 2019, Sonoma County Water Agency

Subject parcel and surrounding area



Sonoma
Water

1:1,355

0 50 100 200 ft

0 15 30 60 m

© OpenStax.org (and) contributors, CC-BY-SA, SONA

Existing Sewer and Parcel to be Served

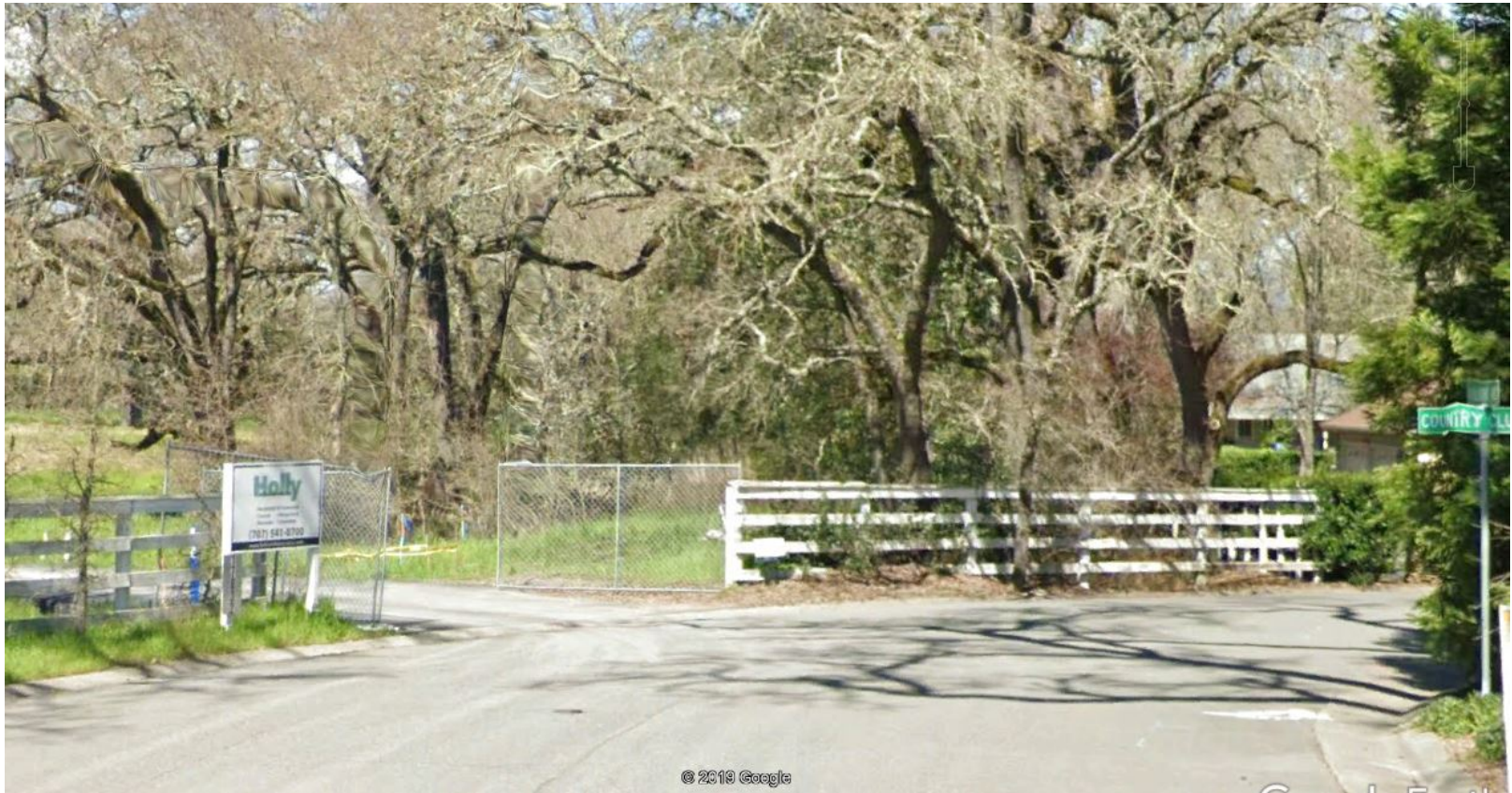

View toward North

Undeveloped continuation of Railroad Avenue



Sonoma
Water

Trees, including oaks, where Sanitation Code requires sewer to be installed

August 2, 2019

Scale: 1:1,355
0 50 100 200 ft
0 15 30 60 m

© Open Street Map (and) contributors, CC-BY-SA, SONMA
Copyright 2019, Sonoma County Water Agency



Requested Action

Adopt Resolution granting the requested variances to Section 3.19 of the Sonoma Valley County Sanitation District Sanitation Code





**Sonoma
Water**

Douglas Messenger
WATER AGENCY ENGINEER
Douglas.messenger@scwa.ca.gov



sonomawater.ca.gov