

- WATER SUPPLY NOTES:**
1. LOT A WELL AND WATER LINE EASEMENT AND AGREEMENT
DOC. NO. 2008-046032 SONOMA COUNTY RECORDS
 2. LOT B WELL AND WATER LINE EASEMENT AND AGREEMENT
DOC. NO. 2016-069049 SONOMA COUNTY RECORDS

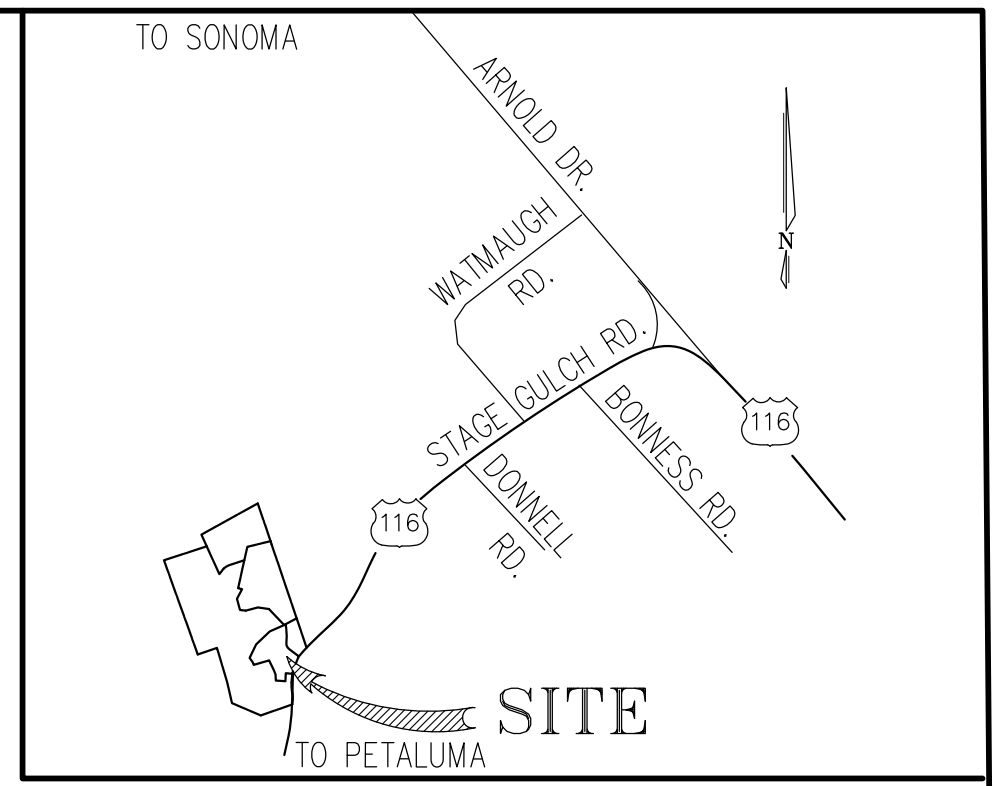

VICINITY MAP
NOT TO SCALE

- LEGEND**
- APPROXIMATE PROPERTY LINE
 - - - PROPOSED NEW LOT LINE
 - - - LOT LINE TO ADJUST
 - ⊙ WELL

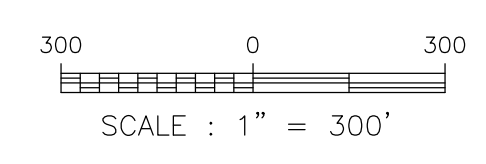

PROPOSED PARCELS:

LOT "A"

APN: 142-051-042 DOC. NO.: 2008-042302
142-051-040, 142-050-041, 142-051-039
142-051-043

EXISTING PARCEL SIZE: 140.25 AC. ±
PROPOSED FINAL PARCEL SIZE: 140.25 AC. ±

OWNER: OLYMPIC SUN LLC
1920 TIENDA DRIVE SUITE 204
LODI CA, 95242
PHONE # (707) 927-5180
ADDRESS: 4202 STAGE GULCH ROAD
SONOMA, CA

LOT "B"

APN: 142-051-032 DOC. NO.: 2008-042301
EXISTING PARCEL SIZE: 34.29 AC. ±
PROPOSED FINAL PARCEL SIZE: 34.29 AC. ±

OWNER: OLYMPIC SUN LLC
1920 TIENDA DRIVE SUITE 204
LODI CA, 95242
PHONE # (707) 927-5180
ADDRESS: 4202 STAGE GULCH ROAD
SONOMA, CA

CONTOURS INTERVAL 25 FT
CONTOURS FROM U.S.G.S QUAD



BRIAN ALAN CURTIS, P.L.S. 8485
EXP. 12/31/20

ALL DISTANCES ARE SHOWN IN FEET AND DECIMALS THEREOF.

**REVISED
LOT LINE ADJUSTMENT
SITE MAP**

FOR A
PROPOSED LOT LINE ADJUSTMENT WITHIN THE LANDS OF
OLYMPIC SUN LLC
A DELAWARE LIMITED LIABILITY COMPANY
AS DESCRIBED IN DOCUMENT NUMBERS
2008-042301, 2008-042302 AND
2016-069051, SONOMA COUNTY RECORDS
LOCATED IN PETALUMA RANCHO, T 5 N ~ R 6 W, M.D.M.
COUNTY OF SONOMA · STATE OF CALIFORNIA
SCALE: 1" = 300' JANUARY, 2020

CURTIS & ASSOCIATES		
805 HEALDSBURG AVE. · HEALDSBURG, CA. 95448 · (707) 433-4808		
A.P.N. 142-051-032, 142-051-042	SHEET 1 OF 1 18-074	
A.P.N. 142-051-040, 142-051-041, 142-051-039, 142-051-043		