

Former General Plan Land Use

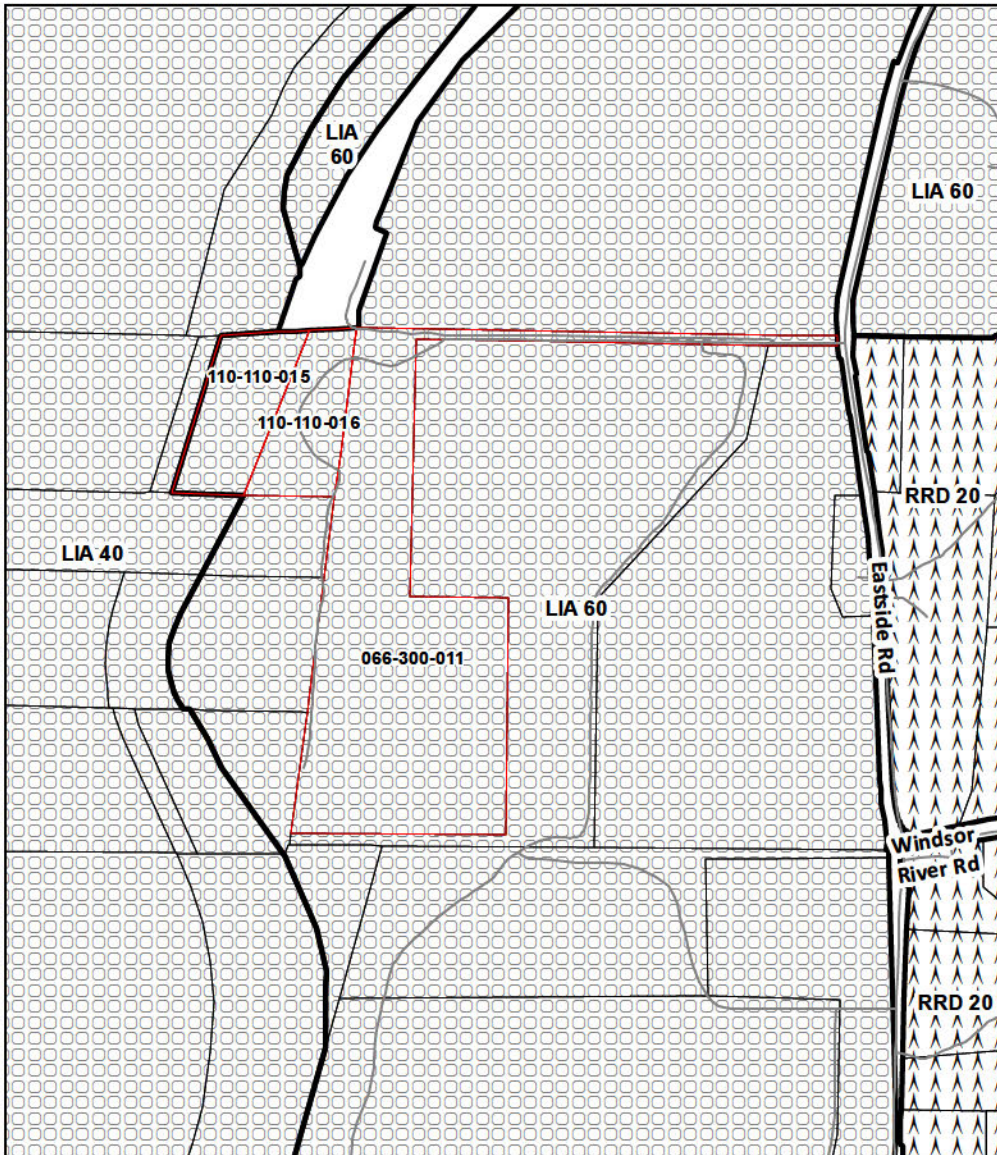

Adopted General Plan Land Use

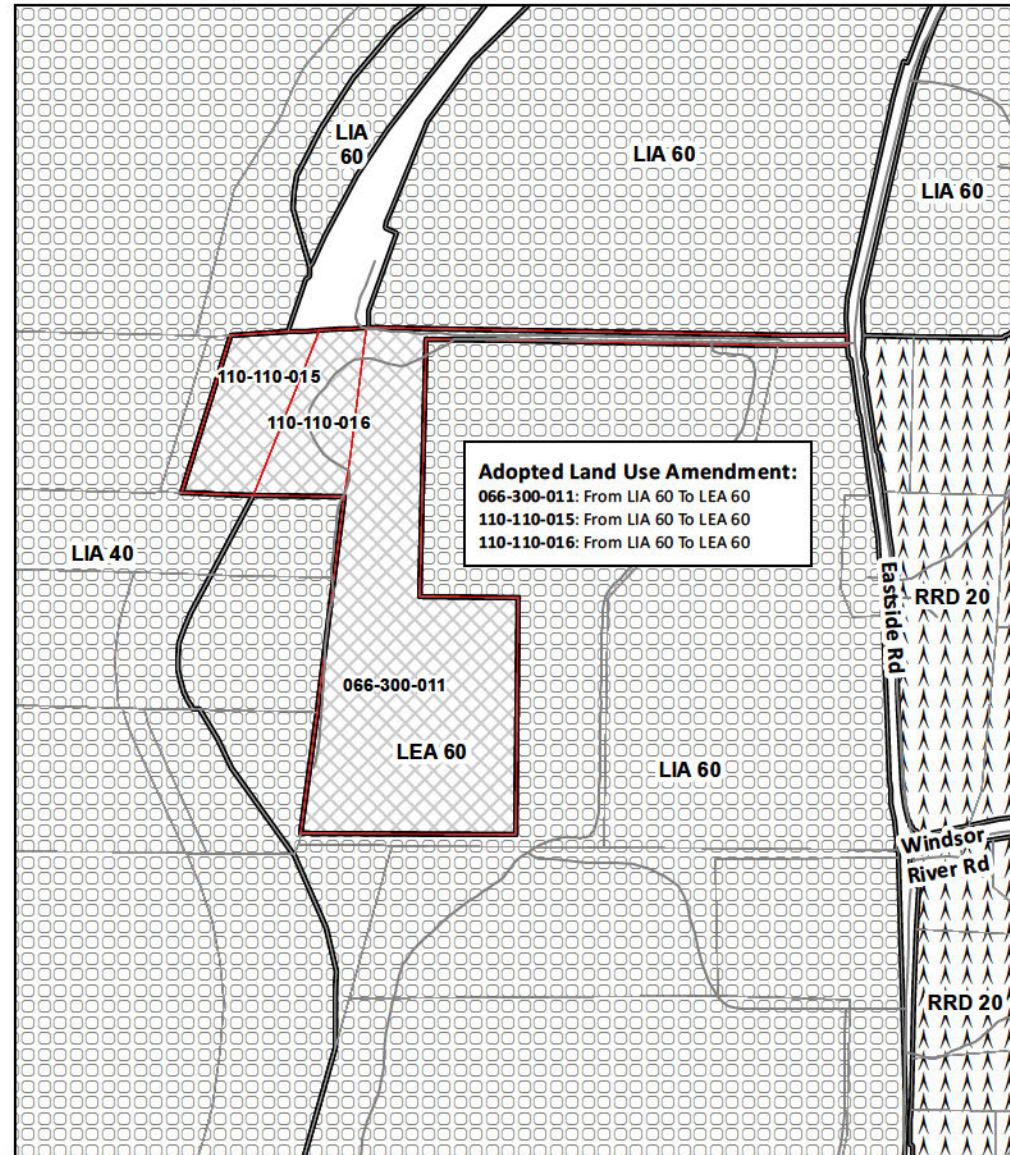

Base Map Data

- Subject Parcel
- Parcel
- Land Use by Area
- Street

General Plan Land Use

- Land Extensive Agriculture
- Land Intensive Agriculture
- Resource and Rural Development

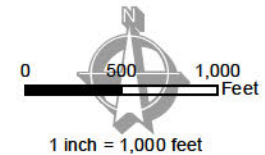

FILE: PLP23-0014
 APNs: 066-300-011
 110-110-015, -016
 Resolution No. TBD

Permit and Resource Management Department
 Project Review Section
 2550 Ventura Avenue, Santa Rosa, CA 95403
 (707) 565-1965 Fax (707) 565-1103