

KEY NOTES:

- 1 THIS ROAD SHALL BE USED FOR EMERGENCY EXIT AND ACCESS TO/FROM ADJACENT SITE ONLY. ACCESS TO AND FROM CA-12 VIA WEISE ROAD WILL BE FOR EMERGENCIES ONLY
- 2 EXISTING ACCESS ROAD SHALL BE IMPROVED AS NEEDED TO MEET FIRE SAFETY STANDARDS.
- 3 SEE BIOLOGICAL ASSESSMENTS PREPARED BY WEMEYER ECOLOGICAL SCIENCES FOR REQUIRED SETBACKS FROM DRAINAGE CHANNELS AND SEASONAL WETLANDS. ALSO SEE CREEK EVALUATION REPORT BY LUCY MACMILLAN, DATED JUNE 5, 2020.
- 4 EXISTING WELL AND WATER TANK WILL SUPPLY IRRIGATION WATER FOR ALL CULTIVATION SITES.
- 5 WASTEWATER FROM SEPTIC TANK WILL BE PUMPED TO LEACHFIELD AT ADJACENT NORTHERN PROPERTY (APN 053-100-015) UNDER SEP18-0544.

CULTIVATION SITE SUMMARY:

- 1 (P) OUTDOOR CULTIVATION - 60,000 SF (CSCF, LLC.)
 - A. CULTIVATION CANOPY NOT TO EXCEED 28,560 SF PER SEASON.
 - B. GREEN WASTE COMPOST - 300 SF (10'x30'), INCLUDES ALLOCATION FOR ALL NON-PROCESSING AREAS
 - C. TRASH ENCLOSURE AND AREA OF CANNABIS SCHEDULED FOR DESTRUCTION - 100 SF (10'x10')
 - D. PESTICIDE/CHEMICAL STORAGE - 100 SF (10'x10')
 - E. PROCESSING, TO OCCUR IN PROCESSING BUILDING
- 2 (P) MIXED LIGHT GREEN HOUSE, PROPAGATION, AND WHOLESALE NURSERY - 70,560 SF (CSCF, LLC.)
 - A. MIXED LIGHT CULTIVATION CANOPY NOT TO EXCEED 10,000 SF.
 - B. PROPAGATION AREA NOT TO EXCEED 10,890 SF
 - C. INDOOR WHOLESALE NURSERY CANOPY NOT TO EXCEED 5,000 SF
 - D. GREEN WASTE COMPOST - PART OF OUTDOOR COMPOST AREA, SEE OUTDOOR CULTIVATION
 - E. TRASH ENCLOSURE AND AREA OF CANNABIS SCHEDULED FOR DESTRUCTION - 100 SF (10'x10')
 - F. PROCESSING - TO OCCUR IN PROCESSING BUILDING
 - G. PESTICIDE/CHEMICAL STORAGE - 100 SF (10'x10')
- 3 (P) CENTRALIZED PROCESSING - 20,000 SF (WCMC, INC.)
 - A. CENTRALIZED PROCESSING
 - B. HARVESTED CANNABIS WILL BE STORED INSIDE
 - C. COMPOST AREA - 4,000 SF (40'x100')

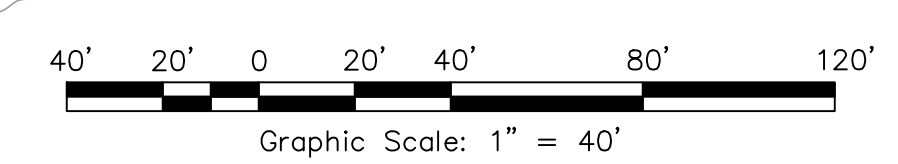
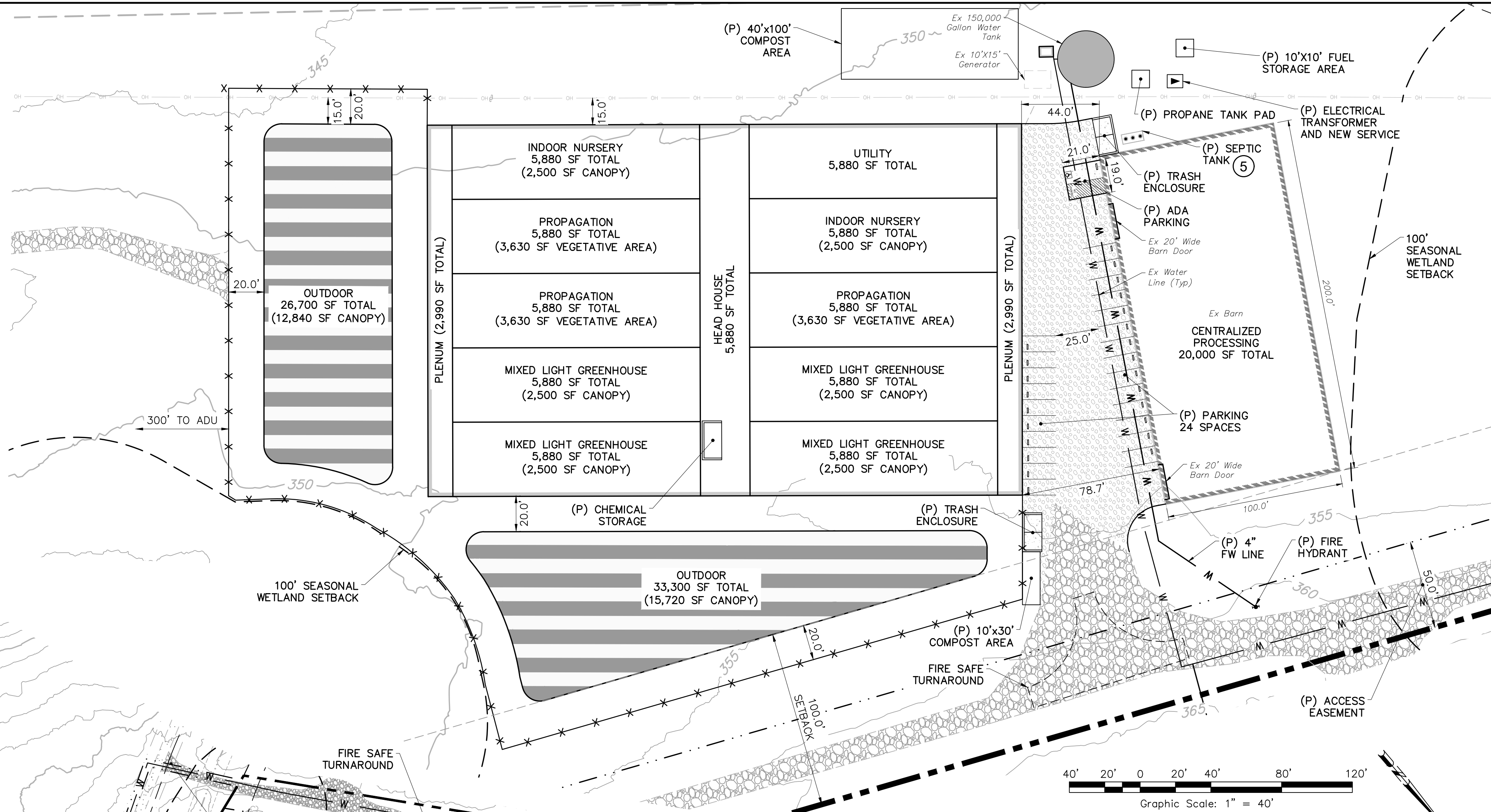

SITE PLAN

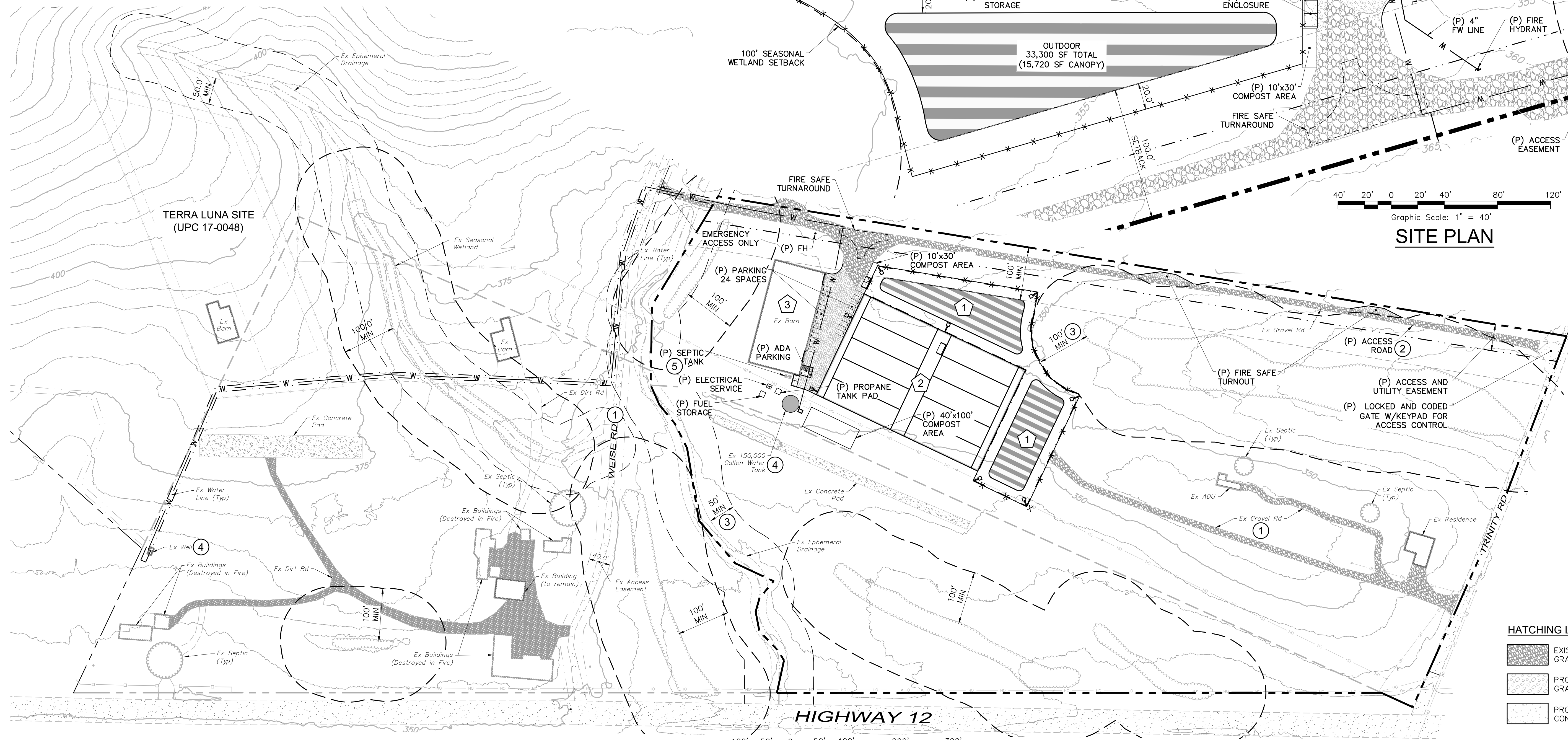

SITE ACCESS & WATER SUPPLY PLAN

No.	Date	Description	Approved

adobe associates, inc.
 civil engineering / land surveying / wastewater
 11200 N. Dutton Ave., Suite 100, CA 95401
 P: (707) 541-2300 F: (707) 541-2301
 Website: www.adobeinc.com
 "A Service You Can Count On!"

David R. Brown, RCE #41833
 My license expires 3/31/2020

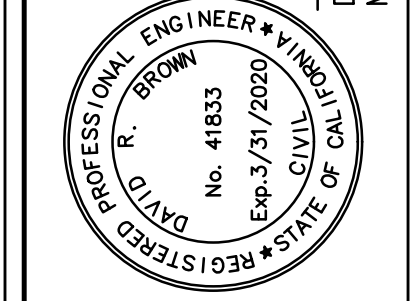

LANDS OF GORDENKER TURKEY FARMS
CANNABIS CULTIVATION PERMIT
SITE, ACCESS & WATER SUPPLY PLAN
 101 Trinity Road
 Glen Ellen, California
 APN 053-130-009 & 053-110-001

SCALE: AS SHOWN
 Date: DECEMBER 1, 2020
 Design by: BFC
 Drawn by: BFC
 Checked by: NAME

Sheet
C3.0
 of 5 Sheets
 Job 19268

T:\2019 PROJECTS\19268\Design\Use Permits\Use Permits\Turkey Farm\Site Plan.dwg, Brandon Clymer, 12/1/2020 12:37:35 PM